

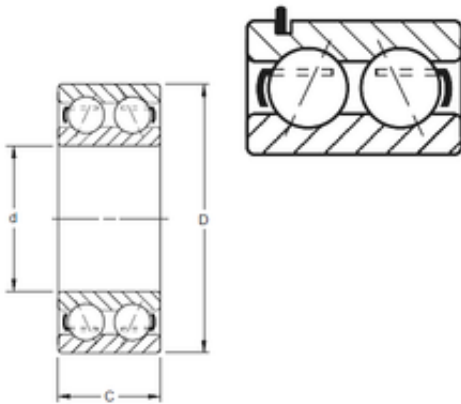

MACHINE PRECISION AXLE CORP.

TIMKEN 5308KG Angular Contact Ball Bearings

Bearing No. 5308KG



5308KG Bearing 2D drawings and 3D CAD models

Size	40x90x36.53 mm
Bore Diameter	40 mm
Outer Diameter	90 mm
Width	36,53 mm
d	40 mm
D	90 mm
C	36,53 mm
Angle ()	30 °
Weight	1,102 Kg
Basic dynamic load rating (C)	90,6 kN